

Detailed Access Guide
Plan view and access measurements for Walnut Cottage

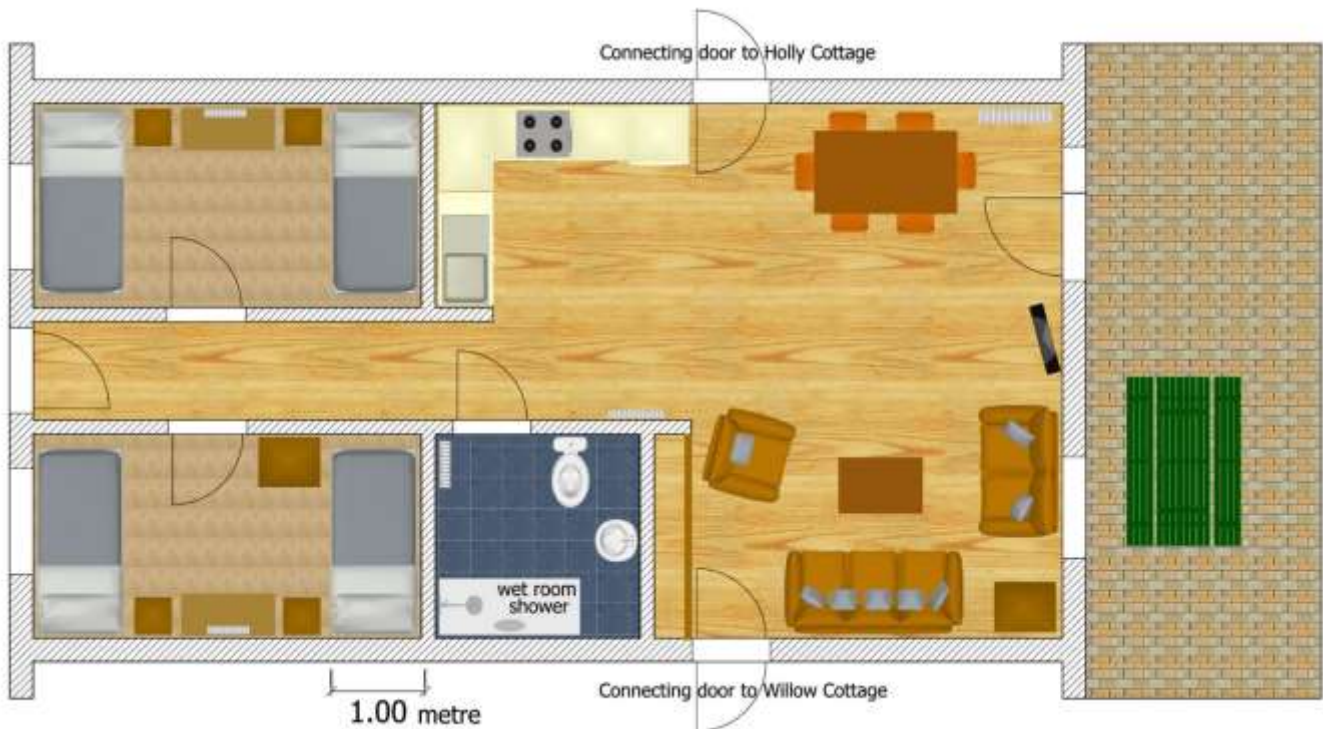

Entrance door:

- Doorbell press button 1050mm high
- Door lever handle 890mm high
- Door with a clear opening width of 820mm
- Rubber door step 10mm high leading into the hallway

Hall:

- Level access wooden floor which continues into kitchen, dining and lounge areas
- Light switch on left hand side at 1220mm high
- Double 3 pin socket 670mm high
- Light switch for hall, lounge and kitchen on left hand side at 1100mm high

Bedroom 1:

- Level access from the hall with a carpet floor
- Door lever handle 1000mm high
- Doorway 820mm wide with a clear opening width of 790mm
- Pull cord at the entrance of the bedroom door starting at 750mm from the floor
- 2 single beds with 150mm gap from the floor to the bed base
- 540mm from the floor to the top of the mattress
- Bedside table, one next to each bed, 600mm high with top surface of 400mm by 410mm
- Bedside light switches and sockets above each bedside table at 800mm high
- Convector radiator isolator at 800mm high
- Convector radiator thermostat under dressing table fixed on the convector at 230mm high
- Dressing table 760mm high with top surface 1000mm by 470mm

- Dressing table underneath clearance of 570mm
- Dressing table stool 420mm high with top surface of 350mm by 480mm
- Wall mirror 890mm to bottom of mirror and 1390mm to top of mirror, 750mm wide
- Wardrobe drawer knobs 300mm high
- Wardrobe door knobs 1180mm high
- Wardrobe hanging rail can be moved between 1200mm or 1600mm high
- Wardrobe top shelf fixed at 1680mm high

Bedroom 2:

- No wardrobe to give more space for a wheelchair/Hangers on wall hooks 1600mm high

Kitchen/dining area:

- Level access from the hall with a wooden floor
- Worktops 900mm high and 600mm deep
- 3 pin sockets above worktops at 1150mm high with 600mm depth of reach
- Kitchen sink lever operated taps
- Oven door handle 690mm
- Hob unit flush mounted in worktops at 900mm high
- Hob extractor fan switch and lights at 1700mm high
- Hob isolator at 1150mm high with 600mm depth of reach
- Microwave on the worktop
- Kitchen cupboards under worktop
- Wall mounted Fire blanket with pull tabs 900mm high
- Kitchen cupboards above worktop
- Fridge freezer combined
- Inter-connecting cottage door, door handle 1000mm high
- Inter-connecting cottage door, clear door opening of 785mm
- Kitchen table 770mm high with top surface at 880mm by 1520mm
- Kitchen table underneath clearance 600mm high
- Kitchen table underneath clearance at one end of the table at 690mm high
- Kitchen chairs, seat at 460mm high
- Waste bin
- Convector radiator thermostat 470mm high
- Convector radiator isolator at 660mm high

Lounge:

- Level access floor with a wood floor
- Storage heater control 690mm high
- Storage heater isolator at 690mm high
- Patio door handle at 1030mm high
- Patio door will give a clear opening width of 830mm
- Patio door curtain is pulled across by hand, curtain extends from floor to ceiling
- Light switches for outside light and lounge lights at 1120mm next to patio door
- TV wall sockets and aerial 670mm high
- TV, Freeview and DVD player operated by handset controls
- Coffee table 480mm high with top surface at 900mm by 600mm
- Waste bin
- Reading lamp
- Sofa seats are 450mm high
- Window sill 780mm high
- Window retaining handle 820mm high
- Window lower lockable retaining handle 1080mm high
- Window upper lockable retaining handle 1700mm high
- Curtains pull across by hand, lowest point at 550mm
- Lounge cupboard door handle at 1000mm high
- Ironing board height is variable between 690mm and 860mm
- Clothes airer

Shower/wet room:

- Level access from the hall with tiled wet room floor surface throughout
- Light switch, left of door before entry 1100mm high
- Door handle 1000mm high
- Door lock 950mm high
- Door clear opening width of 820mm
- Door horizontal hand rail fixed on the inside at 800mm high 600mm long
- Toilet pan 500mm high
- Toilet flushing buttons on wall 1000mm high
- Toilet roll 770mm high
- Fixed horizontal hand rail on left hand side of toilet 740mm high and 600mm long
- Horizontal swing down hand rail on right hand side of toilet 760mm high and 700mm long
- Shaver socket integrated with mirror 1100mm high
- Mirror 970mm from floor to the bottom edge
- Washbasin fixed semi-pedestal 780mm high
- Washbasin mixer lever water tap
- Washbasin fixed vertical handrail from 800mm to 1400mm high
- Shower fixed horizontal handrail 700mm high, 600mm long
- Shower hand held, on/off and temperature controls 1000mm high
- Shower fixed head 2000mm high
- Soap dish 1000mm high
- Shower seat 480mm high
- Heated towel rail
- Heated towel rail isolator at 400mm high



Patio:

- Level access through the patio door in the lounge with 20mm high low threshold sloped rubber door step leading to block paving 2500mm wide, picnic table and level access to the lawn
- Picnic table 720mm high

If further information is required please email us at carol@elmsfarmcottages.co.uk or fill out our enquiry form on our website at www.elmsfarmcottages.co.uk/contact-us.html